

# KITISURU *aman* —GARDENS—



**BROCHURE**  
PROJECT COMPLETION MARCH 2022



## WELCOME TO KITISURU AMANI GARDENS

Within Kitisuru, exactly 1.9 kilometers from the International School of Kenya lies Kitisuru Amani Gardens. This is a lifestyle development which combines ambience, convenience, comfort and luxury living. It is an architectural master-piece that will transform the skyline of Kitisuru.

It comprises of 2 and 3 Bedroom apartments, all master ensuite with fabulous finishes

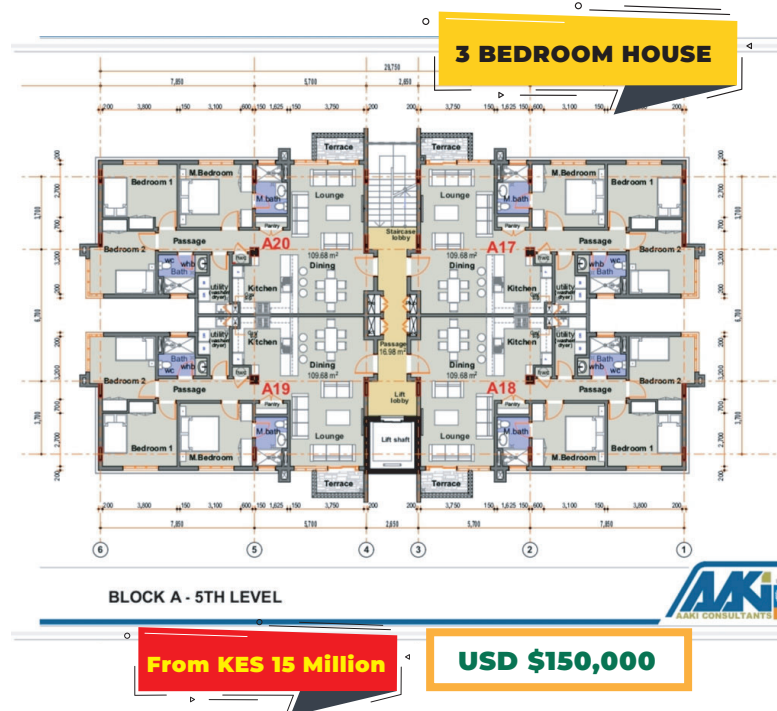
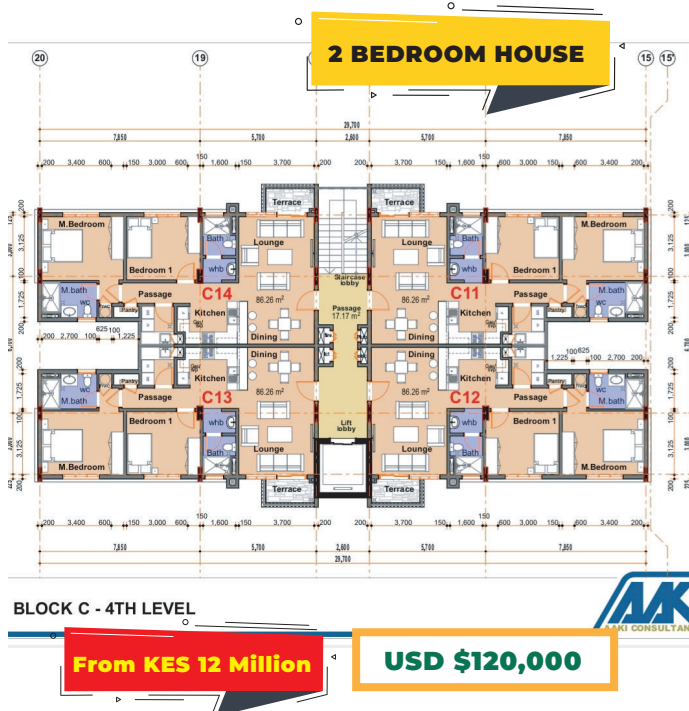















**Own your House Today**  
*Enjoy upto 3% cash discounts*



# *It's not just a Home. It's a Lifestyle.*



## AMMENITIES

-  **Cabro paved driveways**
-  **24 hr manned security gate**
-  **Clean and reliable borehole water**
-  **Underground water storage tanks**
-  **Swimming Pool**
-  **Backups Generator**
-  **CCTV Security System**
-  **Clubhouse**
-  **Gym**
-  **High Speed Lift**
-  **Garden Roof**
-  **Aerial Cabling**
-  **All Masterbed's are ensuite.**
-  **Solar panels and in every house with a cylinder to connect to supply hot water to each house for free.**



## PAYMENT PLAN

10% deposit, 80% during construction period and finally 10% after completion

### **SOCIAL AMENITIES:**

#### **(1) SCHOOLS**

International school of Kenya,  
School of Nations,  
Kirawa school.

#### **(2) HOSPITAL**

Village Medical Center,  
Aga Khan University Hospital,  
Oasis Health Specialty Hospital,  
& Nairobi Hospital Outpatient.

#### **(3) CHURCHES**

ACK St Stephen,  
Chrisco city Church Kitisuru,  
ACK St Andrews & St Catherine of Siena Catholic church

#### **(4) MALLS**

Two Rivers (also known as the eye of Kenya) this is actually the biggest mall in East and Central Africa as per today, then Village Market.

We are only about 200m away from main tarmac road.

# CONTACT US

*Kitisuru Amani Gardens*

*Along Kirawa Road*

*1.9 Kms from International School of Kenya*

*P.O. Box 10405 - 00100*

*Nairobi.*

[info@www.kitisuruamanigardens.com](mailto:info@www.kitisuruamanigardens.com)

[www.kitisuruamanigardens.com](http://www.kitisuruamanigardens.com)



**+254 792 525 592 | +254 111 796 492 | +205 5660 658**